

7. Dimensiones totales y de montaje (mm)

NC1-09~32

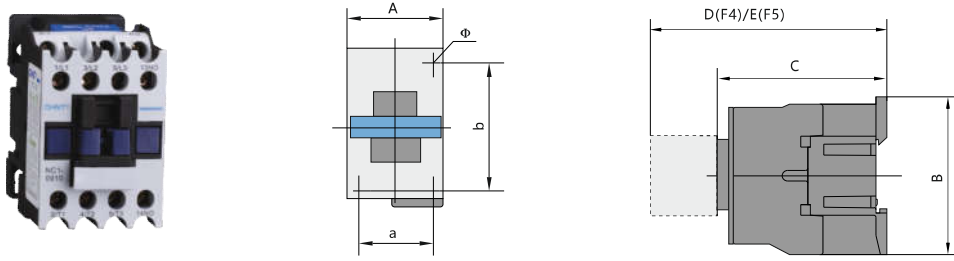

NC1-40~95

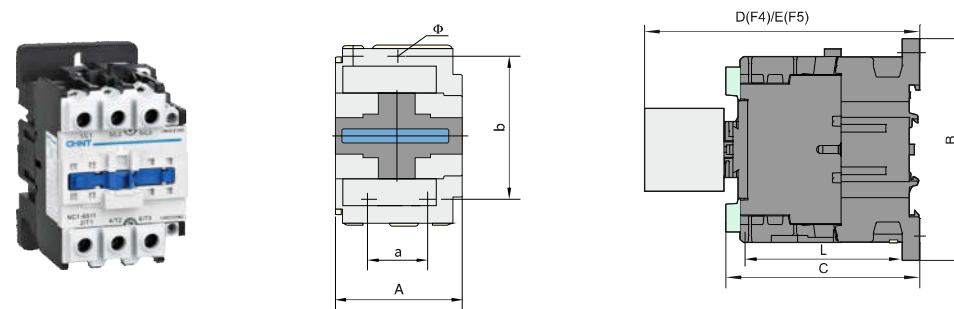

NC1-09Z~32Z

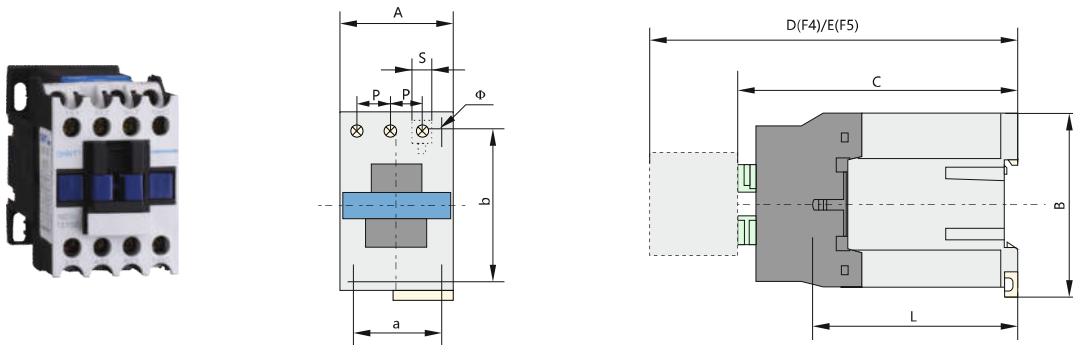

NC1-40Z~95Z

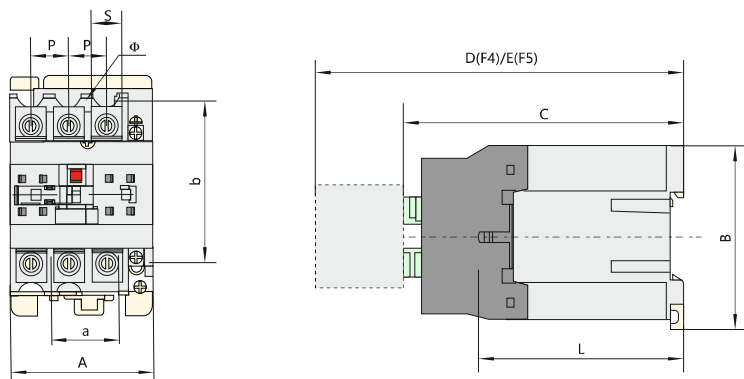

Modelo	A máx	B máx	C máx	D máx	E máx	a	b	Φ	L	P	S
NC1-09(Z)~12(Z)	47	76	82(116)	120.5(154.5)	140.5(174.5)	34/35	50/60	4.5	60(95)	10.5	8.6
NC1-18(Z)	47	76	87(122)	125.5(160.5)	145.5(180.5)	34/35	50/60	4.5	61(96)	11.3	10.4
NC1-25(Z)	57	86	95(131)	133.5(169.5)	153.5(189.5)	40	48	4.5	70(107)	13.2	11.7
NC1-32(Z)	57	86	100(138)	138.5(176.5)	158.5(196.5)	40	48	4.5	71.6(120)	14.5	13
NC1-4011(Z)~6511(Z)	77	129	116(173)	154.5(211.5)	174.5(231.5)	40	105	6.5	78(135)	20	8.6
NC1-4004~6504	84	129	116	154.5	174.5	40	105	6.5	78(135)	20	8.6
NC1-4008~6508	84	129	127	154.5	174.5	40	105	6.5	78	20	8.6
NC1-8011(Z)~9511(Z)	87	129	127(188)	165.5(226.5)	185.5(246.5)	40	105	6.5	83(140)	23.5	12
NC1-8004~9504	96	129	122	160.5	180.5	40	105	6.5	83	23.5	12
NC1-8008~9508	96	129	135	160.5	180.5	40	105	6.5	83	23.5	12

NC1-09~32N

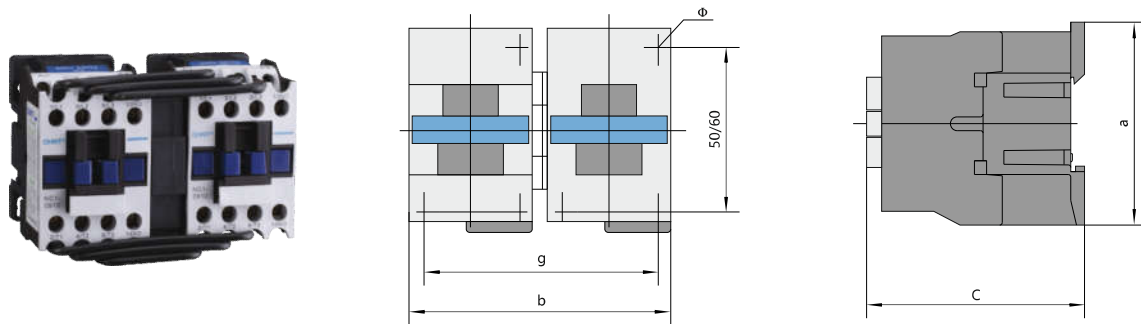

NC1-40~95N

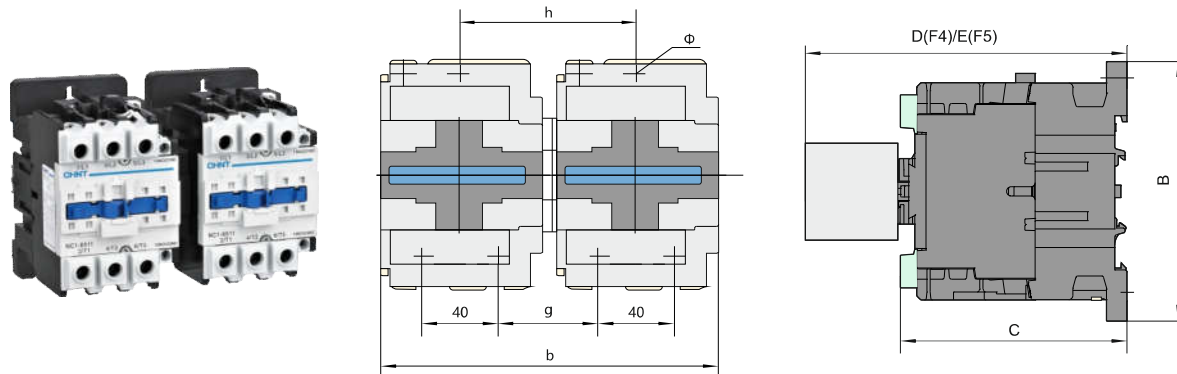

Modelo de contactor	a	b	c	g	h	Φ
NC1-09N~12N	86	Φ	82	95	--	4.5
NC1-18N	86	109	87	95	--	4.5
NC1-25N	93	131	95	111	--	4.5
NC1-32N	93	131	100	111	--	4.5
NC1-40N~65N(3P)	129	165	116	50	90	6.5
NC1-80N~95N(3P)	129	187	127	57	96	6.5
NC1-40N~65N(4P)	129	180	116	50	90	6.5
NC1-80N~95N(4P)	129	205	127	57	96	6.5

Nota:

1. L: en el circuito principal, la distancia entre los terminales y la pletina;
2. P: en el circuito principal, la distancia entre dos fases;
3. S: en el circuito principal, el ancho de la pletina de contacto.