

Technical data sheet

Description

Article number: MZ10468
Type description: V 104/64.0200

Switch diagram

Code Switch

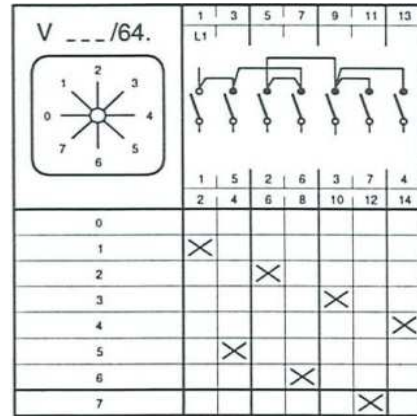

Electrical Data series 104:
 Rated uninterrupted current Ith = 16 A
 Rated operational current Ie AC21 A = 20 A
 Braking capacity AC23B(A) / 400 V = 7,5 kW
 Braking capacity AC3 / 400 V = 5,5 kW
 Isolating characteristic up to 500 V
 Single – phase motor
 1 x 230 V = 2,2 kW
 1 x 400 V = 3 kW

Application

Front mounting with 4-hole fixing
 handle black
 front plate silver
 size 1
 outside: 48x48 mm
 mounting: 36X36 mm

Dimensions (mm)

| A1 | B1 | B2 | D | F | H | S | L according to number of contacts | | | |
|----|----|-----|----|----|----|----|-----------------------------------|-----|-----|-----|
| | | | | | | | 1/2 | 3/4 | 5/6 | 7/8 |
| 36 | 12 | 4,5 | 44 | 48 | 29 | 16 | 41 | 57 | 73 | 89 |

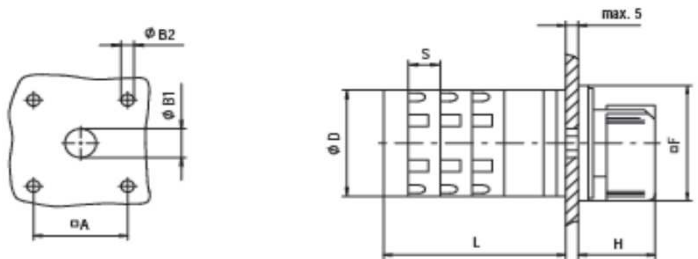

subject to change without notice errors and errata excepted