

Technical data sheet

Description

Article number: MZ17250
Type description: S 151/1.0200

Switch diagram

Star-Delta-Switch

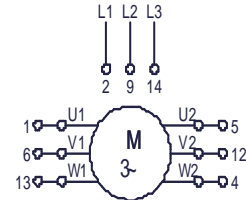
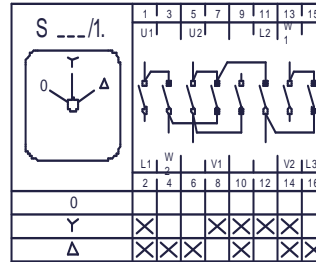

Electrical Data series 151:
 Rated uninterrupted current I_{th} = 32 A
 Rated operational current I_e AC21 A = 25 A
 Braking capacity AC23B(A) / 400 V = 11 kW
 Braking capacity AC3 / 400 V = 7,5 kW
 Isolating characteristic up to 500 V
 Single – phase motor
 1 x 230 V = 3 kW
 1 x 400 V = 4 kW

Application

Front mounting with 4-hole fixing handle
 front plate size 1
 outside: 48x48 mm
 mounting: 36X36 mm

Dimensions (mm)

L according to number of contacts

A	B1	B2	D	F	H	S	1/2	3/4	5/6	7/8
36	12	4,5	49	48	29	12,5	45,5	58	70,5	83

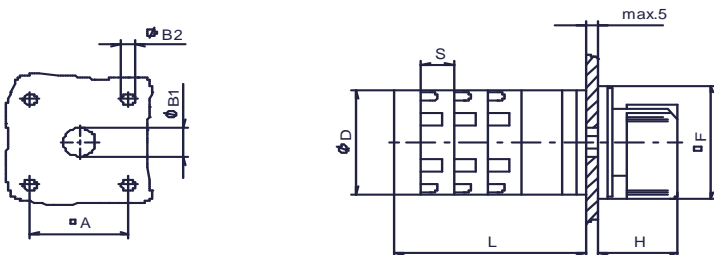

subject to change without notice errors and errata excepted