

Technical data sheet

Description

Article number: MZ19250
Type description: S 251/1.0400

Switch diagram

Star-Delta-Switch

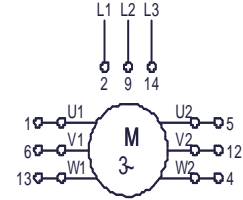
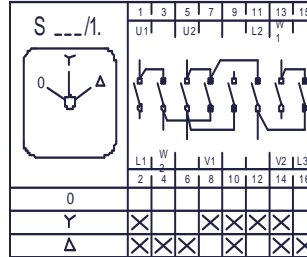

Electrical Data series 251:
 Rated uninterrupted current I_{th} = 40 A
 Rated operational current I_e AC21 A = 32 A
 Braking capacity AC23B(A) / 400 V = 15 kW
 Braking capacity AC3 / 400 V = 11 kW
 Isolating characteristic up to 500 V
 Single – phase motor
 1 x 230 V = 4 kW
 1 x 400 V = 5,5 kW

Application

Front mounting with 4-hole fixing
 handle black
 front plate silver
 size 2
 outside: 64x64 mm
 mounting: 48X48 mm

Dimensions (mm)

	L according to number of contacts										
A	B1	B2	D	F	H	S	1/2	3/4	5/6	7/8	
48	12	5,5	63	64	33	12,5	49	61,5	74	86,5	

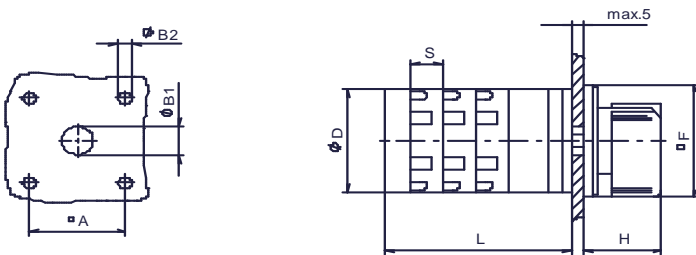

subject to change without notice errors and errata excepted