

## Technical data sheet

### Description

**Article number:** MZ21250  
**Type description:** S 451/1.0400

### Switch diagram

Star-Delta-Switch

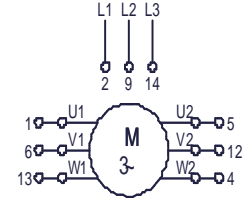
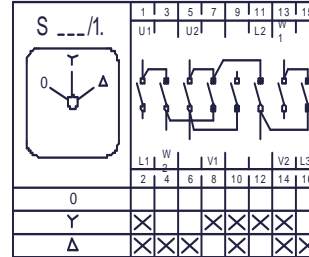

Electrical Data series 451:  
 Rated uninterrupted current I<sub>th</sub> = 63 A  
 Rated operational current I<sub>e</sub> AC21 A = 50 A  
 Braking capacity AC23B(A) / 400 V = 22 kW  
 Braking capacity AC3 / 400 V = 18,5 kW  
 Isolating characteristic up to 500 V  
 Single – phase motor  
 1 x 230 V = 5,5 kW  
 1 x 400 V = 7 kW

### Application

Front mounting with 4-hole fixing  
 handle black  
 front plate silver  
 size 2  
 outside: 64x64 mm  
 mounting: 48x48 mm

### Dimensions (mm)

A	B1	B2	D	F	H	S	L according to number of contacts			
							1/2	3/4	5/6	7/8
48	12	5,5	72	64	33	17,5	54	71,5	89	106,5

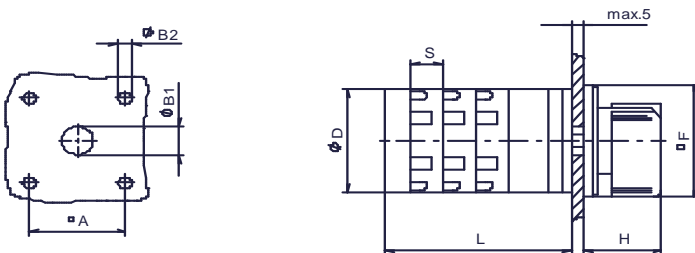

subject to change without notice errors and errata excepted