

Technical data sheet

Description

Article number: MZ25191
Type description: W 656/3.0600

Switch diagram

Reversing Switch

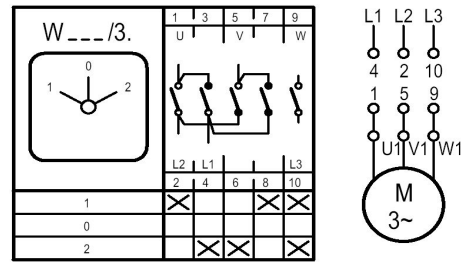

Electrical Data series 656:
 Rated uninterrupted current I_{th} = 80 A
 Rated operational current I_e AC21 A = 80 A
 Braking capacity AC23B(A) / 400 V = 37 kW
 Braking capacity AC3 / 400 V = 37 kW
 Isolating characteristic up to 500 V
 Single – phase motor
 1 x 230 V = 11 kW
 1 x 400 V = 15 kW

Application

Front mounting with 4-hole fixing
 handle black
 front plate silver
 size 3
 outside: 88x88 mm
 mounting: 68X68 mm

Dimensions (mm)

| | | | | | | | | | | | |
|----|----|-----|----|----|----|----|-----|-----------------------------------|-----|-----|--|
| | | | | | | | | L according to number of contacts | | | |
| A | B1 | B2 | D | F | H | S | 1/2 | 3/4 | 5/6 | 7/8 | |
| 68 | 15 | 5,5 | 80 | 88 | 35 | 16 | 54 | 70 | 86 | 102 | |

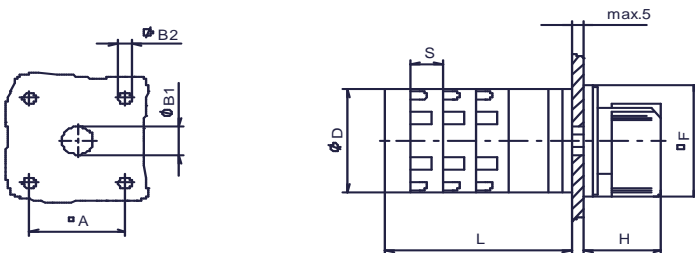

subject to change without notice errors and errata excepted