



# SCHALTGERÄTE

## Komplett-Typen Baureihe MN Complete types Series MN

**Hauptschalter/  
Not-Aus-Schalter**

Fronteinbau

*Main switches  
Emergency-off switches*

*Front mounting*

**Zentralbefestigung  
22,5 und 30,5 mm mit  
Vorhängeschlossperre  
für 3 Vorhängeschlosser**

mit Bügeldurchmesser bis 9 mm

Griff/Frontschild  
rot/gelb rt/ge (mit Not-Aus Funktion)  
oder schwarz/silber sw/si

*Central mounting 22.5 and 30.5 mm  
with lockout handle for 3 padlocks*

*with shackle diameter up to 9 mm*

*handle/front plate  
red/yellow rd/ye (with Emergency-off function)  
or black/silver bk/si*



**Abmessungen / Dimensions  
Bauform / Design: 1560 / 1561**

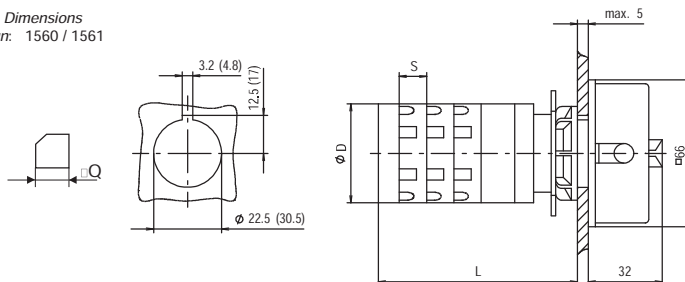

| Baureihe<br>Series | Abmessungen (mm)<br>Dimensions (mm) |      |   | L bei Schaltkontakten<br>L by switch contacts |      |      |       |  |  |  |  |  |  |
|--------------------|-------------------------------------|------|---|---|------|------|-------|--|--|--|--|--|--|
|                    | D                                   | S    | Q | 1/2   | 3/4  | 5/6  | 7/8   |  |  |  |  |  |  |
| 104                | 44                                  | 16   | 6 | 57  | 73   | 89   | 105   |  |  |  |  |  |  |
| 105                | 44                                  | 12.5 | 6 | 48  | 60.5 | 73   | 85.5  |  |  |  |  |  |  |
| 151                | 49                                  | 12.5 | 6 | 68.5  | 81   | 93.5 | 106   |  |  |  |  |  |  |
| 251                | 63                                  | 12   | 6 | 72  | 84.5 | 97   | 109   |  |  |  |  |  |  |
| 451                | 63                                  | 17,5 | 6 | 77  | 94,5 | 112  | 129,5 |  |  |  |  |  |  |

| Schaltprogramm<br>Contact arrangement | Dauerstrom $I_n$<br>Rated<br>Uninterrupted<br>current $I_n$ | Leistung<br>Rating<br>AC 3 | Leistung<br>Rating<br>AC 23A | Baureihe<br>Series | Griff/<br>Frontschild<br>handle/<br>front plate | Typ<br>Type  | Best.Nr.<br>Part # |
|---------------------------------------|---|----------------------------|------------------------------|--------------------|---|--------------|--------------------|
| 3-polig<br>3-pole<br>                 | 20  | 5,5                        | 7,5                          | 104                | rt/ge rd/ye                                     | A 104/6.1560 | MZ 10 109          |
|                                       | 20  | 5,5                        | 7,5                          | 104                | sw/si bk/si                                     | A 104/6.1561 | MZ 10 110          |
|                                       | 25  | 5,5                        | 7,5                          | 105                | rt/ge rd/ye                                     | A 105/6.1560 | MZ 12 109          |
|                                       | 25  | 5,5                        | 7,5                          | 105                | sw/si bk/si                                     | A 105/6.1561 | MZ 12 110          |
|                                       | 32  | 7,5                        | 11                           | 151                | rt/ge rd/ye                                     | A 151/6.1560 | MZ 17 109          |
|                                       | 32  | 7,5                        | 11                           | 151                | sw/si bk/si                                     | A 151/6.1561 | MZ 17 110          |
|                                       | 40  | 11                         | 15                           | 251                | rt/ge rd/ye                                     | A 251/6.1560 | MZ 19 109          |
|                                       | 40  | 11                         | 15                           | 251                | sw/si bk/si                                     | A 251/6.1561 | MZ 19 110          |
|                                       | 63  | 18,5                       | 22                           | 451                | rt/ge rd/ye                                     | A 451/6.1560 | MZ 21 109          |
|                                       | 63  | 18,5                       | 22                           | 451                | sw/si bk/si                                     | A 451/6.1561 | MZ 21 110          |

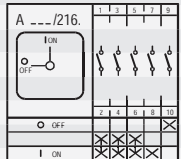
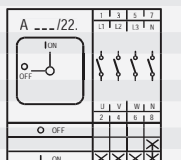
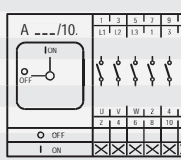
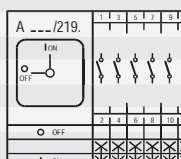
| Schaltprogramm<br>Contact arrangement   | Dauerstrom $I_{rh}$<br>Rated<br>Uninterrupted<br>current $I_{rh}$<br>A | Leistung<br>Rating<br>AC 3<br>kW | Leistung<br>Rating<br>AC 23A<br>kW | Baureihe<br>Series | Griff-/<br>Frontschild<br>handle/<br>front plate | Typ<br>Type    | Best.Nr.<br>Part # |
|---|--|----------------------------------|------------------------------------|--------------------|--|----------------|--------------------|
| 3-polig + 1S + 1Ö<br>3-pole + 1NC + 1NO<br>                    | 20   | 5,5                              | 7,5                                | 104                | rt/ge rd/ye                                      | A 104/216.1560 | MZ 10 145          |
|   | 20   | 5,5                              | 7,5                                | 104                | sw/si bk/si                                      | A 104/216.1561 | MZ 10 146          |
|   | 25   | 5,5                              | 7,5                                | 105                | rt/ge rd/ye                                      | A 105/216.1560 | MZ 12 145          |
|   | 25   | 5,5                              | 7,5                                | 105                | sw/si bk/si                                      | A 105/216.1561 | MZ 12 146          |
|   | 32   | 7,5                              | 11                                 | 151                | rt/ge rd/ye                                      | A 151/216.1560 | MZ 17 145          |
|   | 32   | 7,5                              | 11                                 | 151                | sw/si bk/si                                      | A 151/216.1561 | MZ 17 146          |
|   | 40   | 11                               | 15                                 | 251                | rt/ge rd/ye                                      | A 251/216.1560 | MZ 19 145          |
|   | 40   | 11                               | 15                                 | 251                | sw/si bk/si                                      | A 251/216.1561 | MZ 19 146          |
|   | 63   | 18,5                             | 22                                 | 451                | rt/ge rd/ye                                      | A 451/216.1560 | MZ 21 145          |
|   | 63   | 18,5                             | 22                                 | 451                | sw/si bk/si                                      | A 451/216.1561 | MZ 21 146          |
| 4-polig 1 Kontakt voreilend<br>4-pole 1 contact priority<br> | 20   | 5,5                              | 7,5                                | 104                | rt/ge rd/ye                                      | A 104/22.1560  | MZ 10 111          |
|   | 20   | 5,5                              | 7,5                                | 104                | sw/si bk/si                                      | A 104/22.1561  | MZ 10 112          |
|   | 25   | 5,5                              | 7,5                                | 105                | rt/ge rd/ye                                      | A 105/22.1560  | MZ 12 111          |
|   | 25   | 5,5                              | 7,5                                | 105                | sw/si bk/si                                      | A 105/22.1561  | MZ 12 112          |
|   | 32   | 7,5                              | 11                                 | 151                | rt/ge rd/ye                                      | A 151/22.1560  | MZ 17 111          |
|   | 32   | 7,5                              | 11                                 | 151                | sw/si bk/si                                      | A 151/22.1561  | MZ 17 112          |
|   | 40   | 11                               | 15                                 | 251                | rt/ge rd/ye                                      | A 251/22.1560  | MZ 19 111          |
|   | 40   | 11                               | 15                                 | 251                | sw/si bk/si                                      | A 251/22.1561  | MZ 19 112          |
|   | 63   | 18,5                             | 22                                 | 451                | rt/ge rd/ye                                      | A 451/22.1560  | MZ 21 111          |
|   | 63   | 18,5                             | 22                                 | 451                | sw/si bk/si                                      | A 451/22.1561  | MZ 21 112          |
| 6-polig<br>6-pole<br>  | 20   | 5,5                              | 7,5                                | 104                | rt/ge rd/ye                                      | A 104/10.1560  | MZ 10 115          |
|   | 20   | 5,5                              | 7,5                                | 104                | sw/si bk/si                                      | A 104/10.1561  | MZ 10 116          |
|   | 25   | 5,5                              | 7,5                                | 105                | rt/ge rd/ye                                      | A 105/10.1560  | MZ 12 115          |
|   | 25   | 5,5                              | 7,5                                | 105                | sw/si bk/si                                      | A 105/10.1561  | MZ 12 116          |
|   | 32   | 7,5                              | 11                                 | 151                | rt/ge rd/ye                                      | A 151/10.1560  | MZ 17 115          |
|   | 32   | 7,5                              | 11                                 | 151                | sw/si bk/si                                      | A 151/10.1561  | MZ 17 116          |
|   | 40   | 11                               | 15                                 | 251                | rt/ge rd/ye                                      | A 251/10.1560  | MZ 19 115          |
|   | 40   | 11                               | 15                                 | 251                | sw/si bk/si                                      | A 251/10.1561  | MZ 19 116          |
| 6-polig+ 1S + 1Ö<br>6-pole + 1NC + 1NO<br>                   | 20   | 5,5                              | 7,5                                | 104                | rt/ge rd/ye                                      | A 104/219.1560 | MZ 10 175          |
|   | 20   | 5,5                              | 7,5                                | 104                | sw/si bk/si                                      | A 104/219.1561 | MZ 10 176          |
|   | 25   | 5,5                              | 7,5                                | 105                | rt/ge rd/ye                                      | A 105/219.1560 | MZ 12 175          |
|   | 25   | 5,5                              | 7,5                                | 105                | sw/si bk/si                                      | A 105/219.1561 | MZ 12 176          |
|   | 32   | 7,5                              | 11                                 | 151                | rt/ge rd/ye                                      | A 151/219.1560 | MZ 17 175          |
|   | 32   | 7,5                              | 11                                 | 151                | sw/si bk/si                                      | A 151/219.1561 | MZ 17 176          |
|   | 40   | 11                               | 15                                 | 251                | rt/ge rd/ye                                      | A 251/219.1560 | MZ 19 175          |
|   | 40   | 11                               | 15                                 | 251                | sw/si bk/si                                      | A 251/219.1561 | MZ 19 176          |