

**Technical data sheet**

Description

**Article number:** MZ17212  
**Type description:** P 151/5.0200

Switch diagram

Multi-Speed Switch

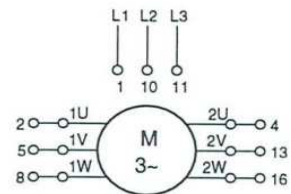
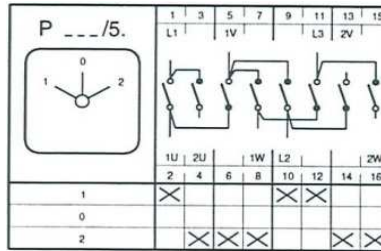

Electrical Data series 151:  
 Rated uninterrupted current I<sub>th</sub> = 32 A  
 Rated operational current I<sub>e</sub> AC21 A = 25 A  
 Braking capacity AC23B(A) / 400 V = 11 kW  
 Braking capacity AC3 / 400 V = 7,5 kW  
 Isolating characteristic up to 500 V  
 Single – phase motor  
 1 x 230 V = 3 kW  
 1 x 400 V = 4 kW

Application

Front mounting with 4-hole fixing handle  
 front plate  
 size 1  
 outside: 48x48 mm  
 mounting: 36X36 mm

Dimensions (mm)

L according to number of contacts  

A	B1	B2	D	F	H	S	1/2	3/4	5/6	7/8
36	12	4,5	49	48	29	12,5	45,5	58	70,5	83

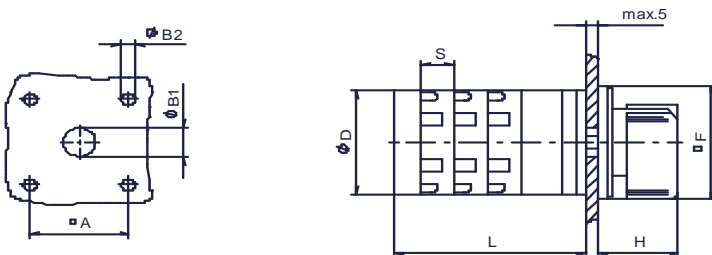

subject to change without notice errors and errata excepted